

# Exploring Sculpture



## A Guide for Families

Prepared by Lacy Bettcher, MST 520 Independent Study in Museum Education  
Museum Studies, Western Illinois University – Quad Cities

563.326.7804  
[www.figgeartmuseum.org](http://www.figgeartmuseum.org)  
Davenport, Iowa

**FIGGE**  
ART MUSEUM

Use this map to find the sculptures. Remember to look with your eyes and not your hands.

# 1 FIGGE PLAZA

## LEVEL 1



## LEVEL 3



## LEVEL 4

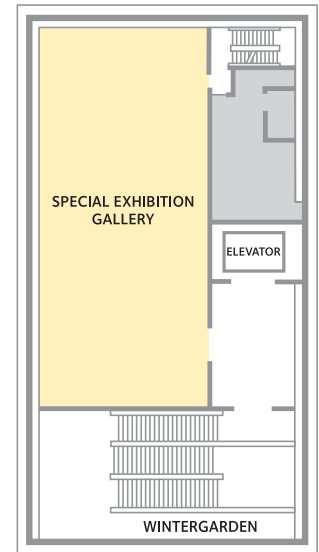

## LEVEL 2

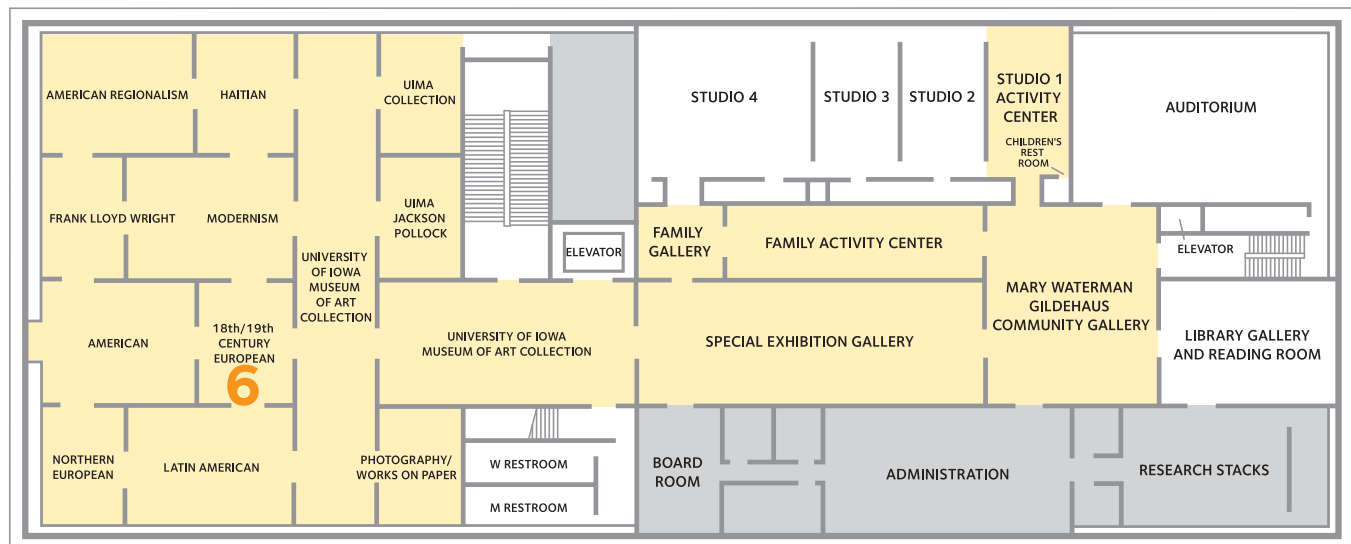

# What is Sculpture?

Sculpture is **three-dimensional**, which means it has height, width, and depth. A sculpture you can walk all the way around is called a **sculpture in the round**.

An artist who creates sculpture is called a **sculptor**. Sculptors can use many different kinds of materials to create their artworks.

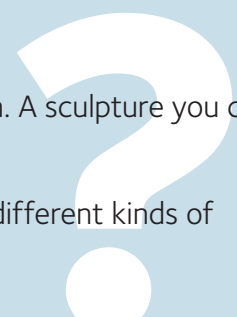

## Let's start on the Figge plaza.

1

Sol Lewitt  
*Tower*

*Tower* is 21 feet high! This tall rectangular sculpture is made of concrete. Note the different **geometric** shapes on each side. Geometric shapes are those that you can draw with a ruler or compass such as:

triangles



circles



squares



List the geometric shapes you see in *Tower*.

_____	_____
_____	_____
_____	_____
_____	_____

Visit the **Family Activity Center** to construct your own *Tower* using a cut-and-fold template.

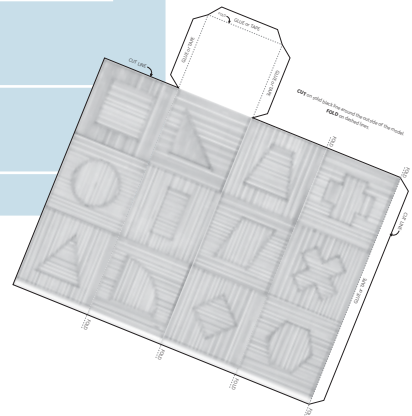

## Let's move inside.

2

**Angelo Granata**  
*Untitled*

This sculpture is made of steel and shaped like a spoon, but some people say it looks like a person. Some people even refer to this sculpture as "Spoon Man."

Many sculptures need to be placed in a climate-controlled space to protect them from hot and cold temperatures. Metal sculptures like this one can be placed anywhere, even by the door.

Angelo Granata studied art at the University of Iowa. Maybe some day you will want to be a sculptor, too!



**Draw a friend for "Spoon Man"**

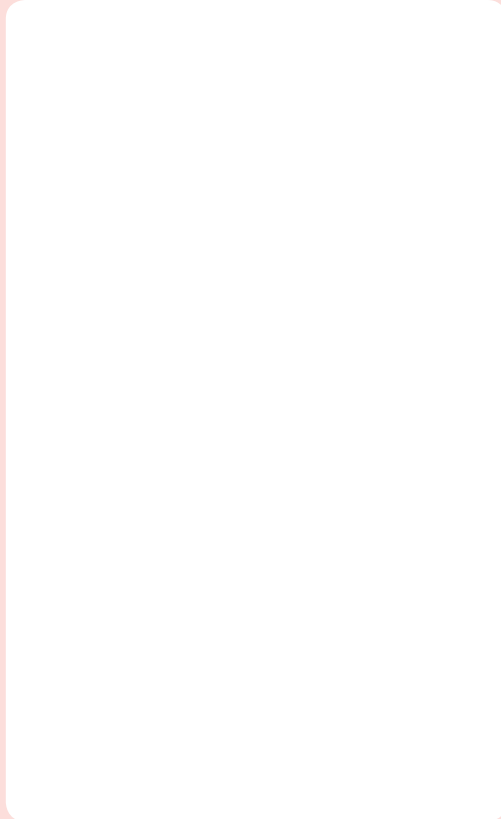

**Angelo Granata's sculpture**

# 3

## Deborah Butterfield *Half-Moon*



Not only are horses Deborah Butterfield's favorite subject, they are her only subject. The artist knows horses well because she rides and trains them on her ranch. Each one of Butterfield's horse sculptures has its own personality. This one is happy to see you. We know this because her head is down, ready to be petted.

This sculpture looks like wood, but it is actually bronze. The artist applied a special coating to make the bronze look like wood. If you could touch this sculpture, it would feel rough like wood and cool like metal.

*Half-Moon* is bigger than a real horse and weighs 2,400 pounds. That is about 50 of you!

**Try drawing a horse like *Half-Moon* when you get home. Place your drawing over tree bark and rub with crayons to make your horse look like wood.**



# 4

**Joseph Louis Juste** (pronounced 'loo-é-jooost')  
*Giraffe*

This sculpture was cut from a flat sheet of metal. The solid parts of the design are called **positive space** and the open spaces are called **negative space**.

How is this sculpture different from the others that you've already seen?

Notice the texture of the sculpture; this helps to make it look more three-dimensional. How would this surface feel if you could touch it?



**The subject matter of this sculpture is a giraffe. Look at the sculptures surrounding the giraffe. What other animals do you see? List them below.**

---

---

---

---

---

---

---

---

---

---

# 5

**Jean-Camille Nasson**  
*Danbala Boat*



To assemble this sculpture, the artist used **found objects** such as the old wooden canoe. Where could you find objects like these? List all the objects you see attached to the canoe.

Look at the people. How many do you see? What do the people and the canoe have in common? Hint: They help you fly.

Make up an adventure story about where this canoe is travelling.



You can create your own sculpture out of found objects. Find out how at <http://tlc.howstuffworks.com/family/sculpture-crafts1.htm>

**Circle the types of materials you have seen so far:**

**Wood**

**Clay**

**Concrete**

**Steel**

**Plastic**

**Bronze**

**Marble**

**Wax**

## Time to go upstairs.

# 6

**Isidore-Jules Bonheur**  
*Jockey on a Horse*

How does this sculpture show movement? Notice how the horse is lifting up its back left leg and right front leg; it looks like the horse is taking a step. Also notice the hoof prints the horse leaves in the base as it's walking.



This sculpture looks a little green because a **patina** (pronounced puh-tee-nuh) has formed on the sculpture's surface. A patina develops naturally through oxidation, which is when the bronze is exposed to air and water.

*Jockey on a Horse* is also an example of **sculpture in the round** because you can walk all around it, viewing it from different angles. Try drawing this horse from either the front or the back like the artist's sister Rosa Bonheur did in her painting of a cow.



Rosa Bonheur, *Study of a Cow*



## Let's head up to the Wintergarden.

# 7

**Seymour Lipton**

*Acrobat*

This artist welded metal forms together and covered them with a nickel silver that had a “hand-hammered” finish. Hammering the metal created a bumpy **texture**.

This sculpture is **non-representational**, which means it does not have a recognizable subject from the real world.

The title of this work is *Acrobat*. Circus acrobats perform a variety of athletic feats, including balancing tricks. How did the sculptor make this sculpture look balanced?



**Circle the words that best describe this sculpture:**

Sharp

Heavy

Smooth

Curvy

Rough

Light

Soft

# Finally, a sculpture you can touch!

8

**Harry Bertoia** (pronounced bur-toy-yuh)  
*Sound Sculpture*

This sculpture is made up of two rows of metal rods. Do these rods remind you of anything from nature?

This sculptor wants you to experience his art by touching it. Gently touching this sculpture produces a sounds that remind you of a wind chime. The sounds reminded the artist of church bells he remembered hearing as a young boy.

*Sound Sculpture* is the only work of art in the museum you can touch. When you touch an object with your bare hands you leave behind fingerprints. Fingerprints are made of sweat and oils that can attack the surface of an object, which leads to staining and deterioration.



**Do you like the sounds this sculpture can make? Would you want this in your room?**

**Before you leave, draw your favorite sculpture.**



**Thanks for visiting the Figge Art Museum!**